

JIBB User Guide

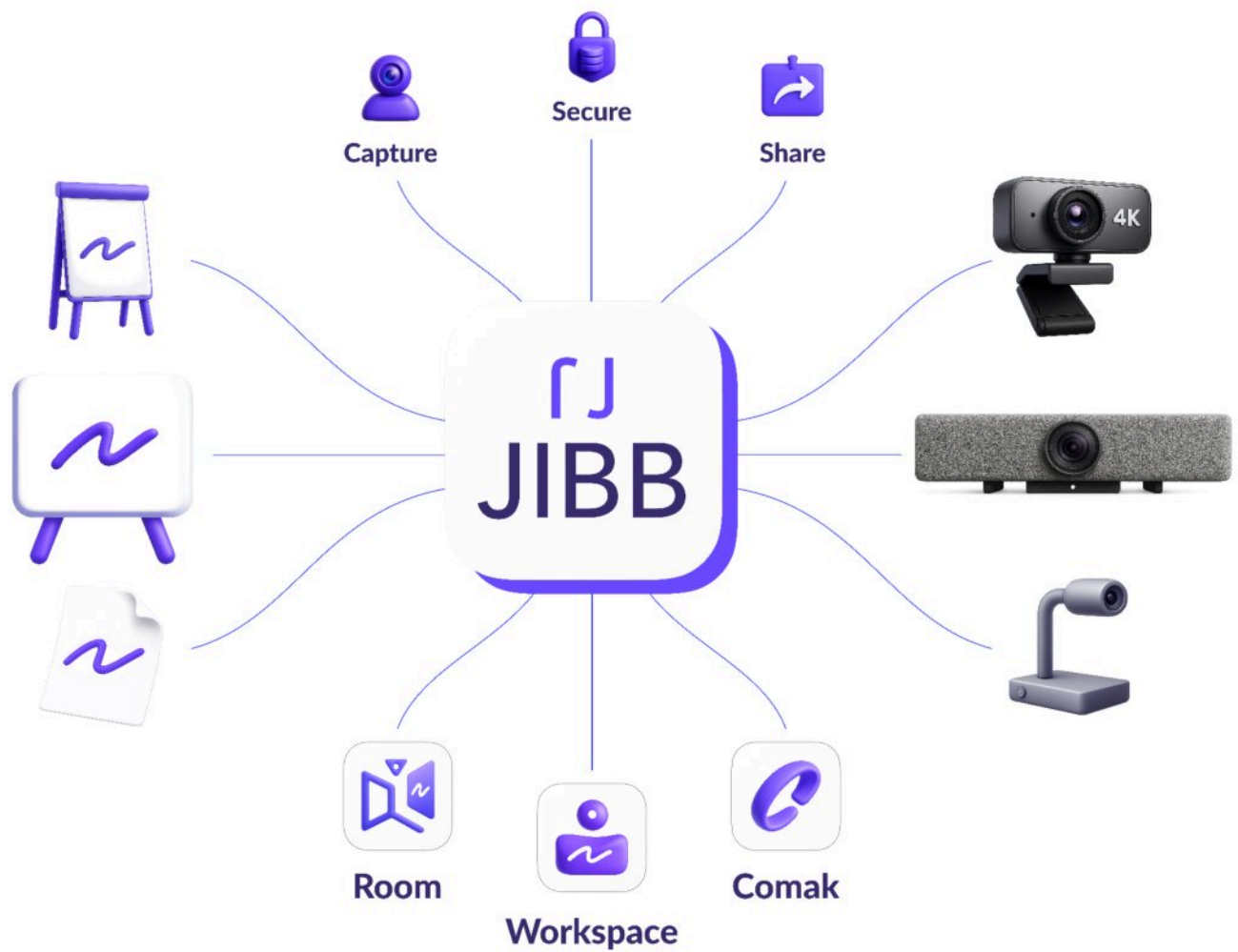

Table of Contents

What is JIBB?	1
Which JIBB Product Should I Start With?	1
JIBB Workspace User Guide	2
<i>What You'll Need</i>	2
<i>Getting Access</i>	3
<i>Setting Up Workspace</i>	3
<i>Sharing Your Work Online</i>	9
<i>Saving Your Work</i>	12
<i>Digitize your Analog Work</i>	15
<i>You're Ready!</i>	17
<i>Need Help?</i>	17
Comak User Guide	18
<i>Getting Access</i>	18
<i>Setting Up Comak</i>	18
<i>Using Comak</i>	21
<i>Working with JIBB Workspace</i>	25
<i>Using Comak on Mobile</i>	26
<i>Integrations</i>	27
<i>You're Ready!</i>	27
<i>Need Help?</i>	28

What is JIBB?

JIBB is an AI platform that makes your handwriting instantly collaborative, perfectly digitized, and ready to share in your favorite tools.

Working in JIBB

JIBB makes visual thinking easy for online collaborators.

Keep your flow

You're a visual thinker, and you work best when there's a pen or marker in your hand and a blank canvas in front of you. JIBB helps you to bring your biggest strength online. As your pen moves across paper or a whiteboard, your work appears on screen instantly. No scanning, no typing, no lag between thought and digital capture. You maintain your natural pace and creative flow while JIBB makes it presentable to an online audience and saves it while you go.

Real-time Collaboration

Bring remote teams into your physical workspace as if they're standing beside you. When you sketch diagrams, work through complex problems, or brainstorm on a whiteboard, your colleagues see every stroke as it happens. They add annotations and feedback in real-time, turning your writing surface into a shared space where distance disappears, and ideas flow freely.

Skip the Redraw

You sketch ideas by hand, and JIBB makes them ready to share. Capture your whiteboard drawings, hand-drawn charts, or brainstorm notes and transform them into polished, editable visuals you can immediately use in presentations, reports, or lessons. No more spending hours recreating your work digitally. You go from rough sketch to finished deliverable in seconds, keeping your creative momentum without the tedious cleanup.

Which JIBB Product Should I Start With?

To decide which product from JIBB to use, you need to decide if you're either presenting/collaborating ([Workspace](#)) or structuring/refining your work ([Comak](#)).



Workspace

Presenting & Collaborating



Comak

Structuring & refining 1

JIBB Workspace User Guide

Welcome to Workspace! This guide walks you through everything you need to know before sharing your whiteboard and paper online. Let's get started.

What You'll Need

You'll set up JIBB with equipment you likely already have. Here's what works best:

1. Your Computer

Use a PC or laptop running Windows or macOS.

 **Note:** While you can use a mobile phone in a pinch, we don't recommend it for regular sessions. You'll get better results with a full computer setup.

2. Your Writing Surface

Choose the surface that fits your workspace:

- **Paper** – Works anywhere, readily available.
- **Whiteboard** – Wall-mounted or desktop, perfect for larger drawings and easy erasing.
- **Lapboard** – Portable desktop option for flexible setups.

Pick based on your space and how you work. Need to erase and reuse? Go with a whiteboard. Working from different locations? Paper gives you flexibility.

3. Your Webcam

You need a camera to capture your writing surface:

- **Built-in laptop camera:** Convenient for paper on your desk.
- **Webcam:** Good for desktop setups with paper or small boards.
- **Plug-and-Play Video Bars:** Best option for larger whiteboards.
- **Document camera:** Best option for paper on your desk.

Document cameras are widely available on Amazon and similar retailers. [See example.](#)



1. Laptop camera
or Webcam



2. Document
Camera



3. Plug-and-Play
Video Bars

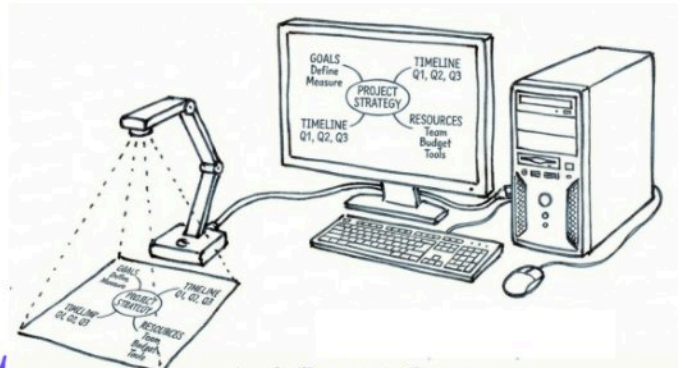

4. A Typical Setup

Getting Access

Visit jibb.ai to get started:

- **New to JIBB?** Start a free trial to explore features.
- **Already a subscriber?** Log in to access your account.

Setting Up Workspace

Now you'll configure JIBB to work with your hardware setup. Follow these steps to connect your physical writing to your digital workspace.

1. Choose Your Product

JIBB offers two products for different needs:

- **Workspace:** For meetings, collaboration, and real-time sharing.
- **Comak:** For transforming sketches into polished diagrams.

This guide focuses on Workspace setup. You can explore Comak after you're comfortable with the basics.

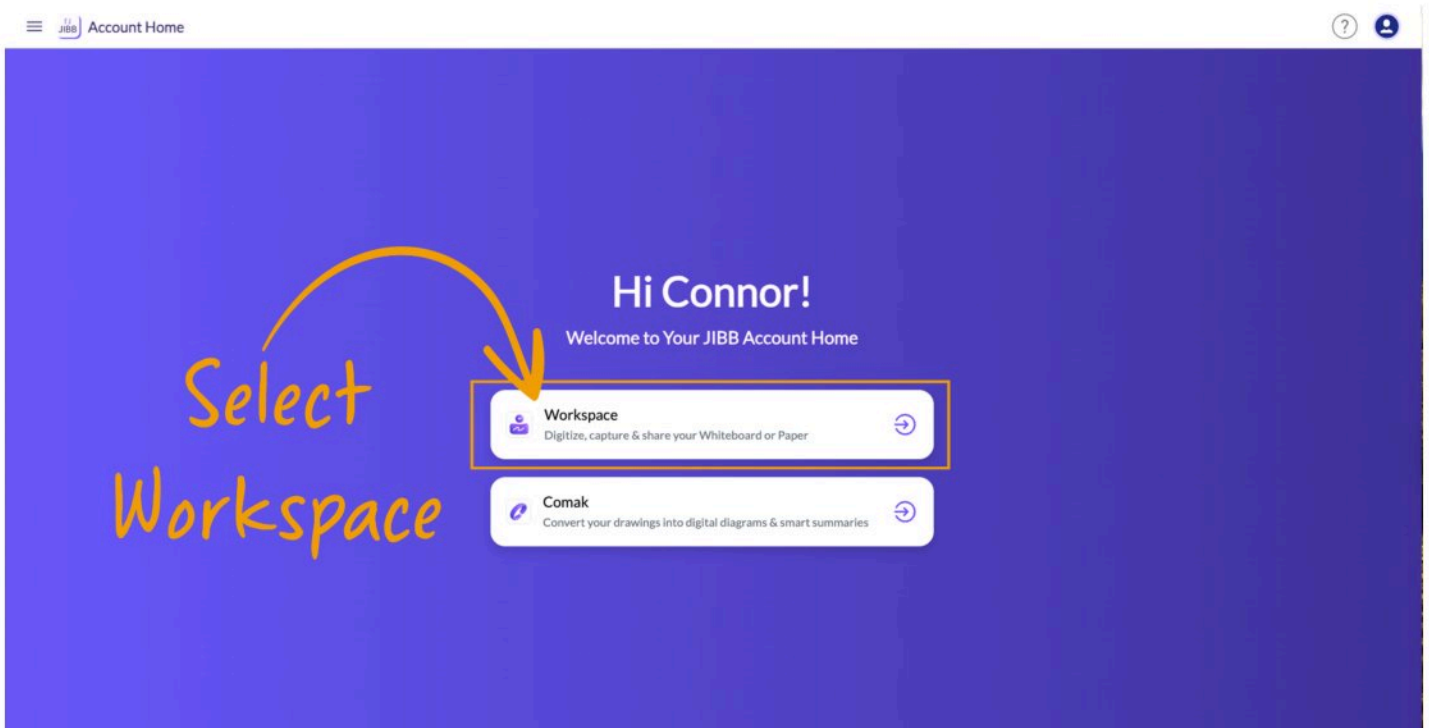

2. Create Your First Workspace

- Click "Workspace" from your dashboard.
- Look for the + sign under "Start a new Workspace".
- Click to create your workspace.

You've just created a dedicated space where you'll write, share, and save your work during sessions.

 **Note:** You can create multiple workspaces for different projects or meetings—keep things organized by creating a new workspace for each session.

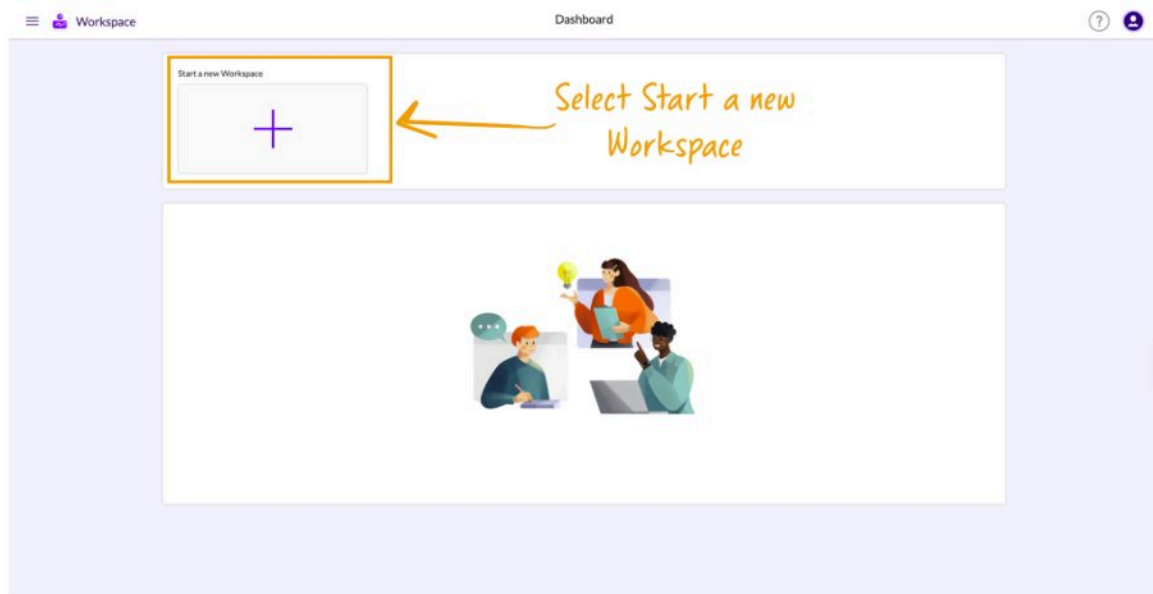

3. Configure Your Control Panel

Once you're in your Workspace environment, you'll set up your camera and writing surface:

- Click the Control Panel (look for the orange icon in the upper right corner).

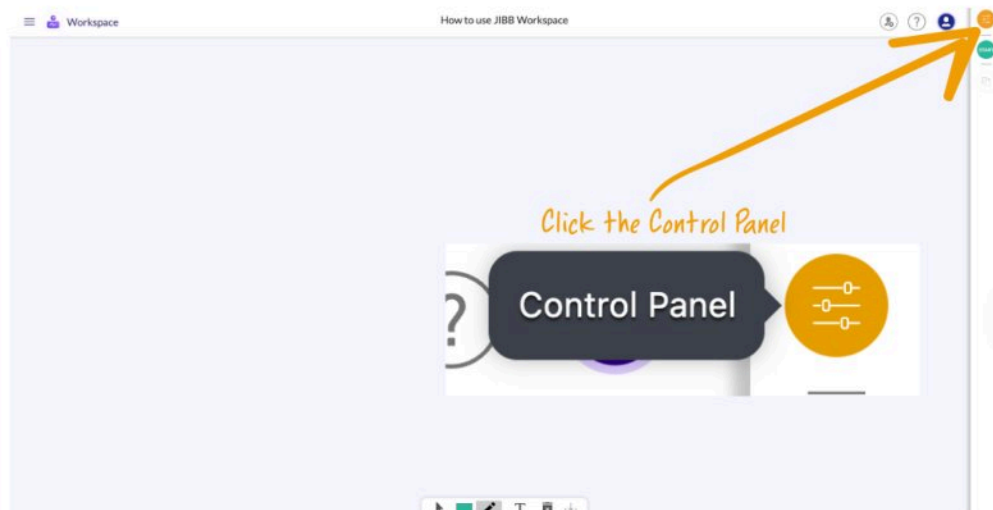

- b. Select your writing surface type from the dropdown.

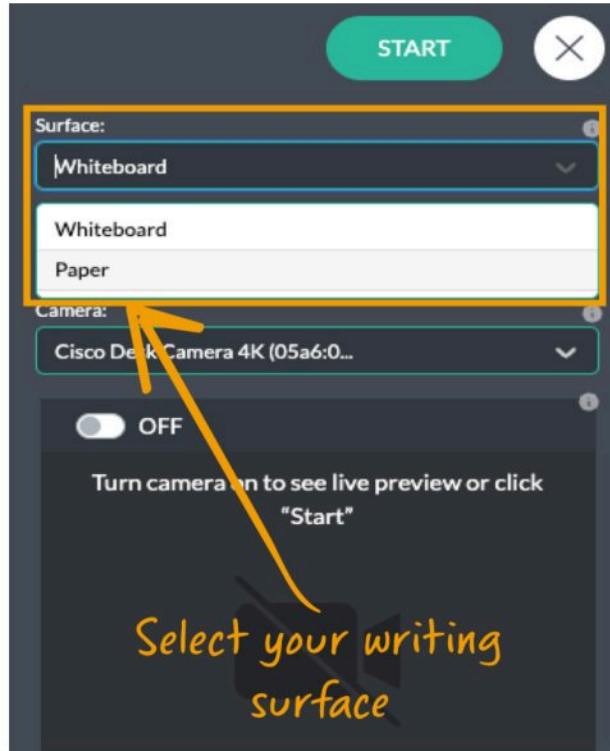

- c. Input source is pre-selected, so you can skip this step.
- d. Select which camera you're using.

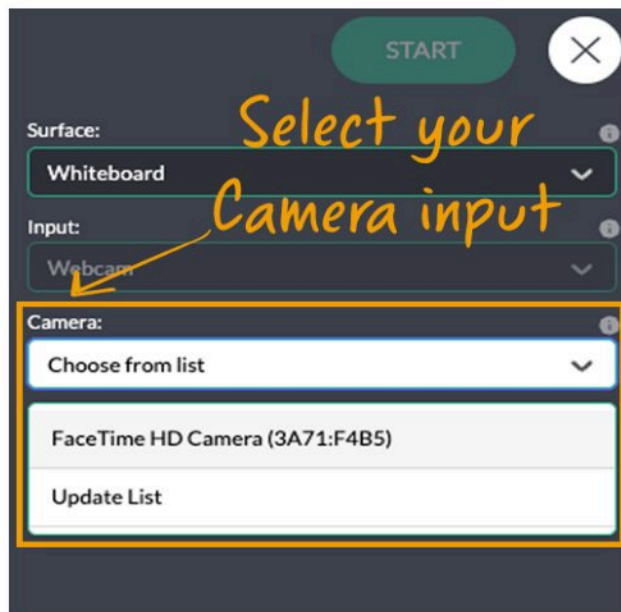

 **Note:** If your device is not visible, select "Update List" to refresh the listing.

4. Position Your Camera

This step ensures Workspace captures your entire writing area clearly.

Align your camera so it has a clear view of your full writing surface. Adjust your camera angle until you can see the entire area where you'll write. You want to make sure the four corners of your writing surface are visible.

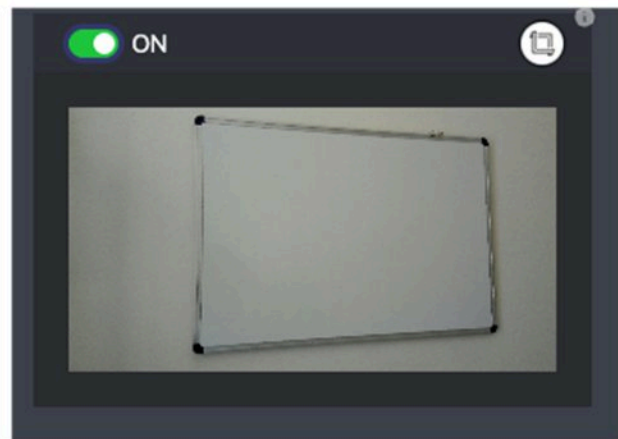
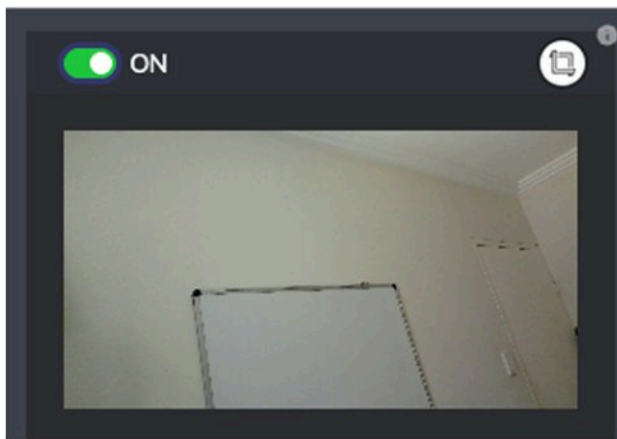

⚠ Important: Make sure lighting is even across your writing surface. Avoid glare or shadows that might make writing hard to capture.

5. Adjust Your Digital Frame

- Click the on/off button in the Control Panel.

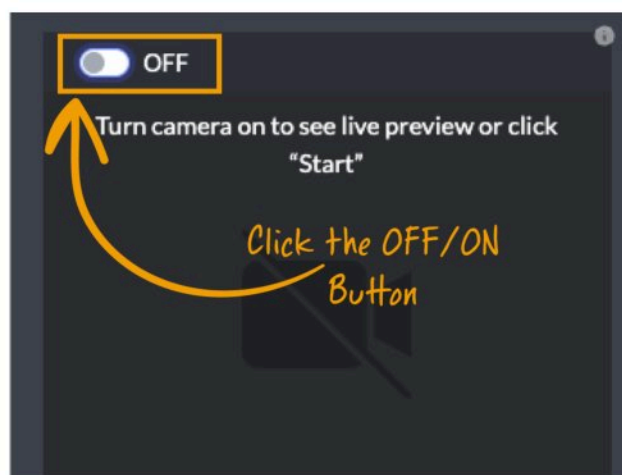

- b. Then click on the manual selection button, identified by a white circle and square frame icon.

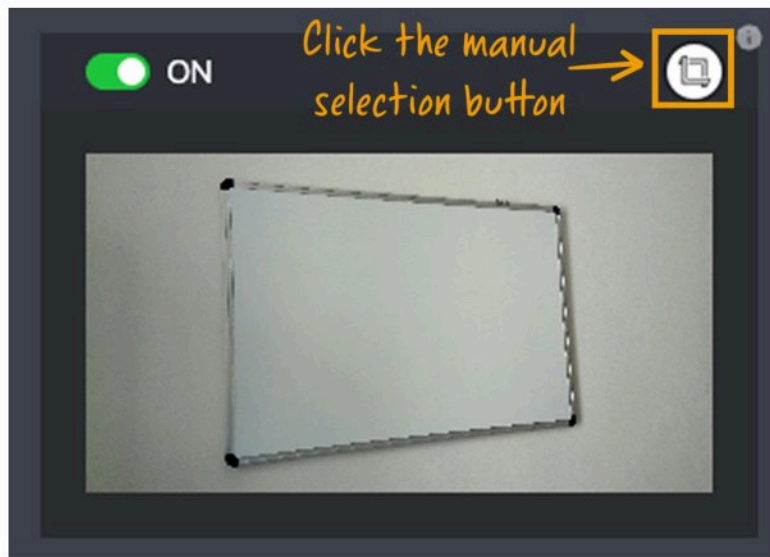

- c. A video window appears showing your writing surface with yellow boundary lines. Drag the yellow lines to create a rectangle that covers your writing area.

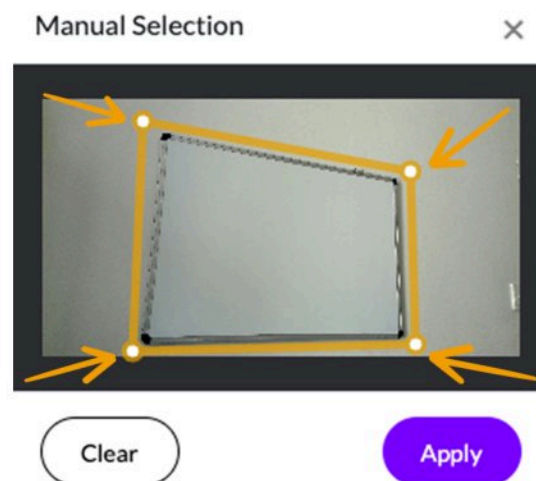

- d. Make sure all four corners are in the frame and give a little bit of breathing space for better detection.

 **Tip:** Take a moment to get this right. A well-framed surface makes everything else work better.

6. Test Your Setup

You're ready to see Workspace in action:

- Click the Start button in your Control Panel.

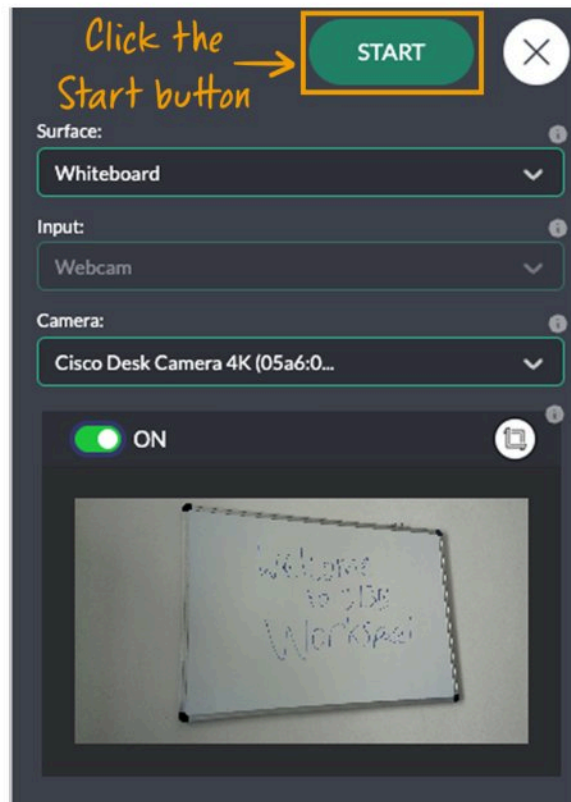

- Write something on your physical surface.
- Watch your writing appear on the left side of your screen in near real-time.

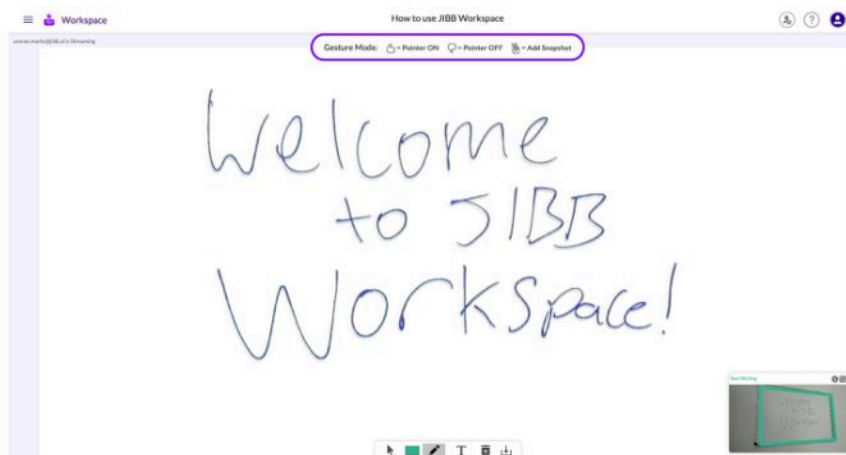

Your handwriting now appears digitally as you create it. You've successfully connected your physical and digital workspace!

Sharing Your Work Online

The power of workspace comes from instant sharing. You can broadcast your handwriting to anyone, anywhere, in real-time. How you share depends on whether you want to simply present or actively collaborate.

Just Presenting? Use Screen Share

Choose the method that fits your workflow:

When you want to show your writing without needing feedback or annotations, screen sharing is the simplest option.

Perfect for: Lectures, presentations, demonstrations, and one-way communication.

How to Present with Screen Share

1. Join your video meeting on Zoom, Webex, Google Meet, or Microsoft Teams.
2. Open your JIBB Workspace.
3. Use your platform's Share Screen function.
4. Select your Workspace window.
5. Your writing broadcasts to everyone as you create it.

Your audience sees everything you write in real-time, just like watching you work on a whiteboard in the office. No additional setup required.

 **Note:** This works perfectly for hybrid meetings where some people are in the room with you, and others join remotely.

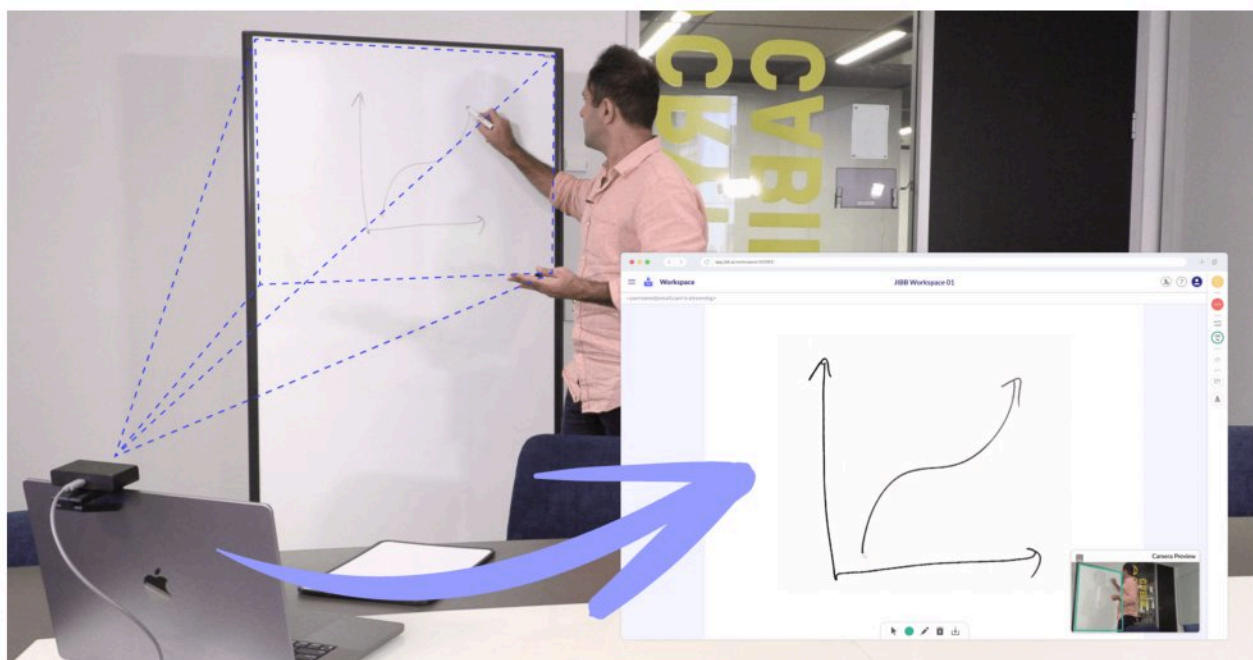

Need Collaboration? Share a JIBB Workspace Link

When you want participants to contribute, annotate, or provide feedback, use Workspaces' built-in collaboration features.

Perfect for: Brainstorming sessions, workshops, team problem-solving, tutor-student exchanges, and interactive meetings.

How to Collaborate with Workspace Links

1. Click the Share button in your Workspace.

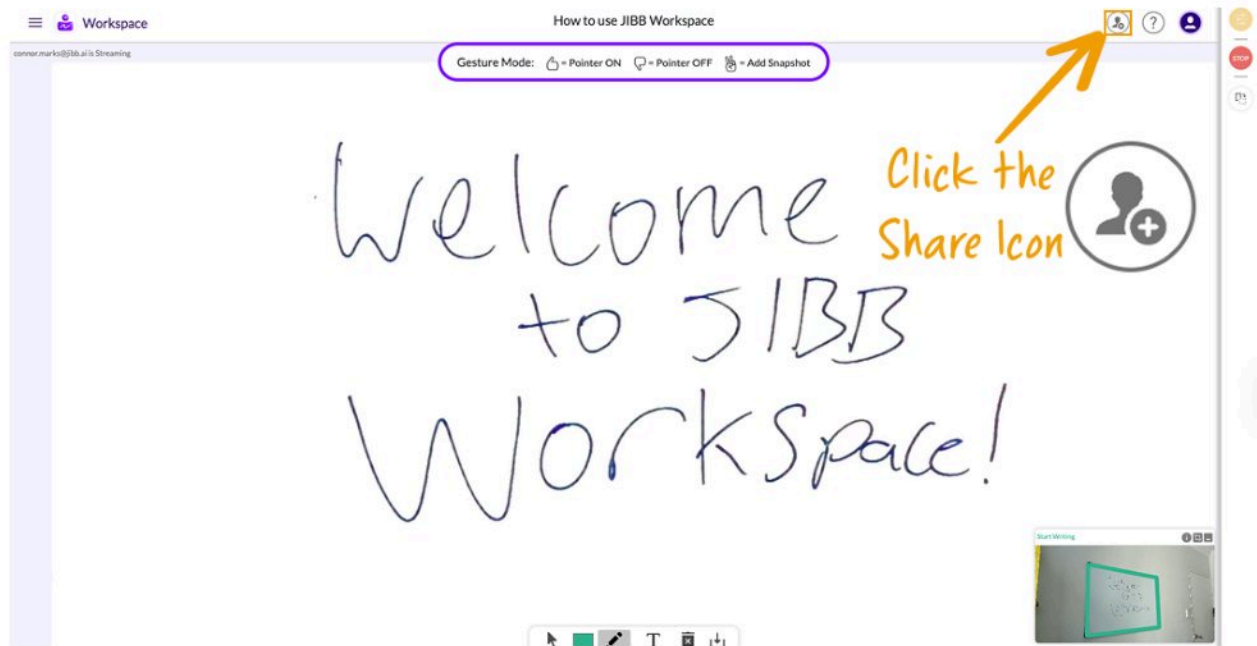

2. To send an invitation, you have 3 options:
 - a. Send an email invitation.
 - b. Copy and send the link directly to your collaborators.
 - c. Have the participants scan the QR code when the screen is shared in your video meeting.

 **Next Page:** Go to the next page to see a diagram of the different options.

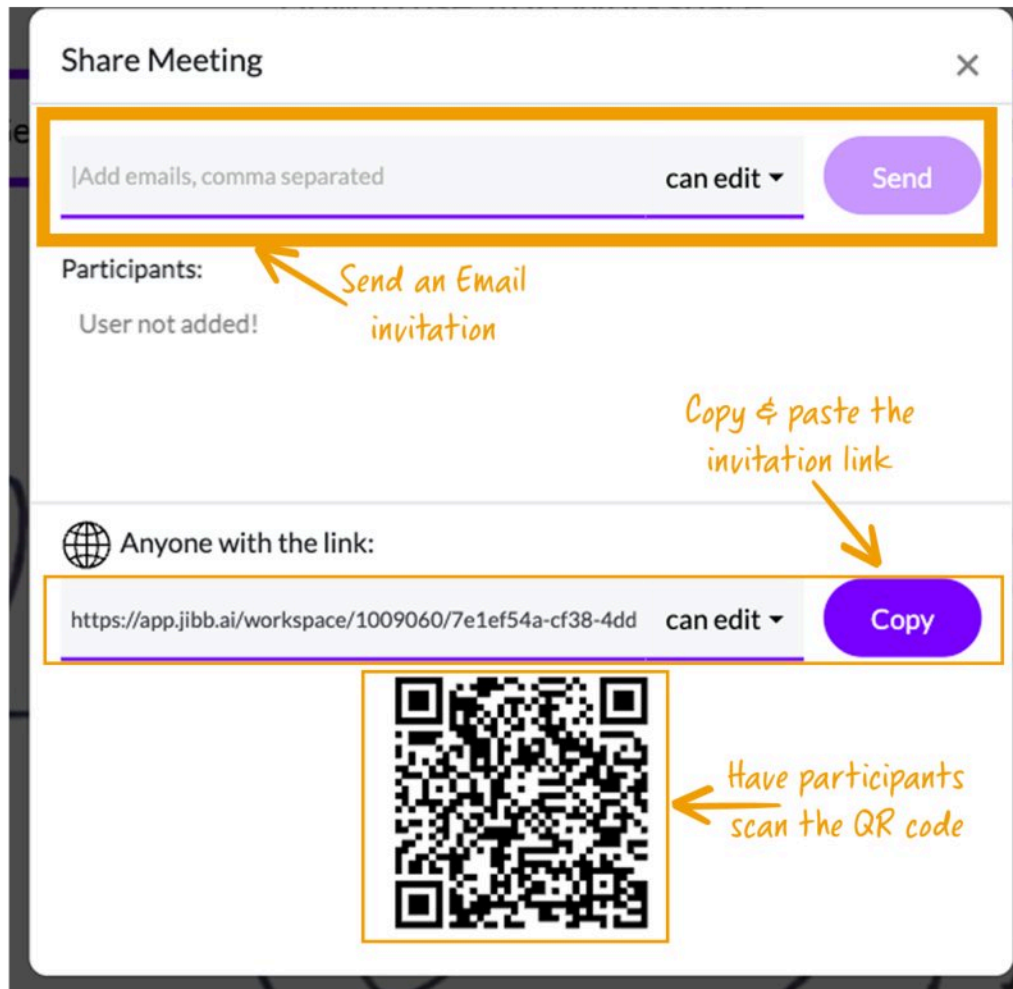

3. The participant joins your session through their browser.
4. Everyone sees your writing in real-time AND can add their own annotations.

Collaborators can view, draw, annotate, and provide feedback without needing their own writing setup—they contribute directly through the shared workspace using annotation tools.

⚠ Important: When you share a Workspace link, participants can actively contribute to the workspace. If you only want to show your work without input, use screen sharing instead.

📺 Video: To see how this all works live, watch the following tutorial on how to collaborate with JIBB workspace. [Click here.](#)

💡 Tip: You can use both methods in the same meeting! Screen share while presenting, then switch to Workspace link sharing when you want group input.

Saving Your Work

JIBB Workspace captures your work so you never lose important ideas or contributions. You have two ways to save: instantly on demand, or automatically in the background.

Manual Saves

Capture your workspace instantly whenever you need it:

1. Click the Save button in your Workspace.

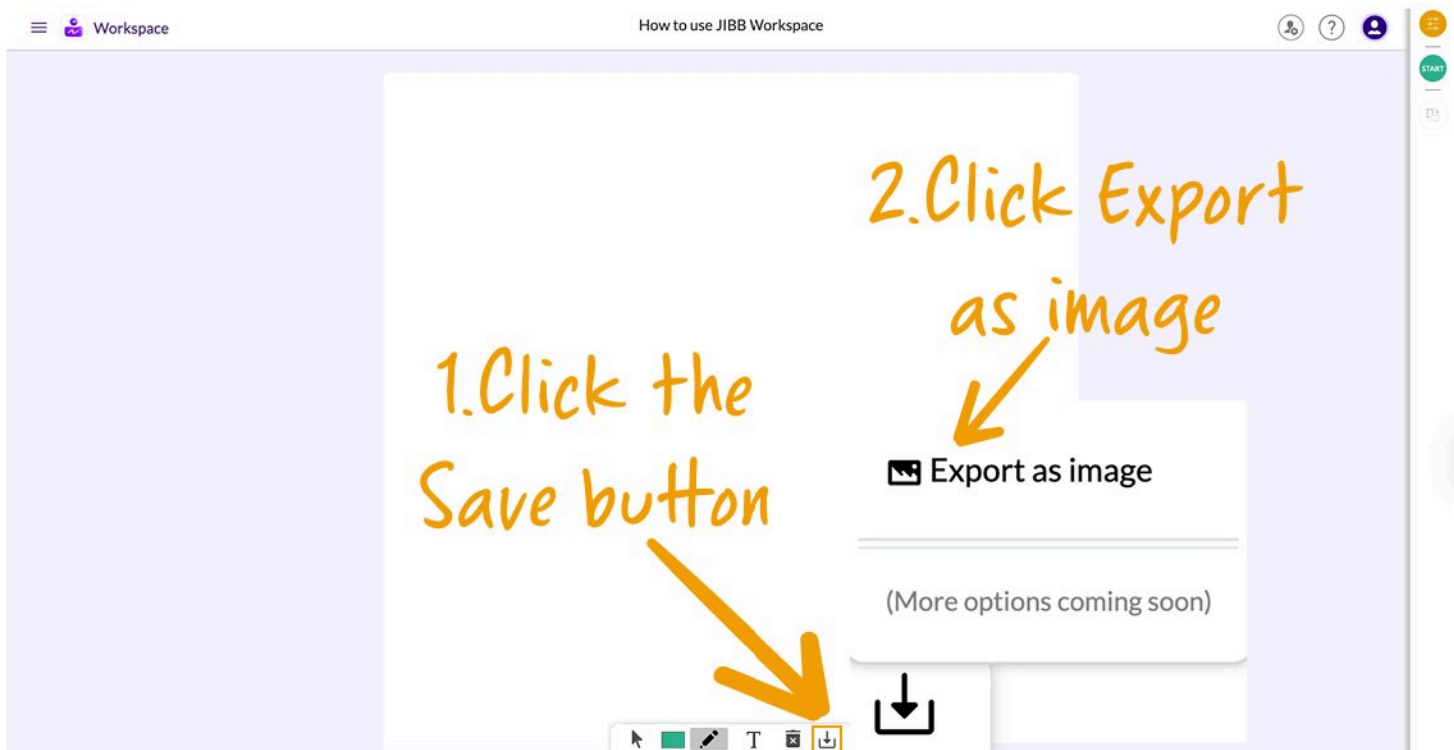

2. Workspace downloads a PNG image of your current progress.
3. Find the file in your computer's Downloads folder.

Use this when you want to capture a specific moment, a completed diagram, a key decision point, or the final stage of your brainstorming session.

Tip: Manual saves give you immediate access to your work as an image file you can drop into presentations, emails, or reports.

Auto-Save

While you work, Workspace quietly monitors your session in the background, tracking significant changes and building a complete record.

How Auto-Save Works

Workspace runs automatically throughout your session—you don't need to configure anything:

1. **Checks every 30 seconds:** Workspace compares progress to detect new content.
2. **Captures additions:** New writing, drawings, or diagrams are recorded.
3. **Ignores removals:** Erased or deleted content doesn't trigger recording.
4. **Smart detection:** Minor changes (like a small dot) are filtered out to focus on meaningful content.
5. **Includes annotations:** Your final record includes annotations from collaborators.

⚠ Important: You don't control when auto-saves happen. This runs entirely in the background. Workspace tracks changes to your written content, not annotation activity alone.

Your Session Summary

After your session ends, Workspace compiles all significant changes into a PDF summary and sends it to your email.

What you receive:

1. A PDF documenting the evolution of your session.
2. Key moments captured when substantial content was added.
3. A visual timeline showing how ideas developed.
4. All annotations from collaborators included.

💡 Note: Check your email after each session for your PDF summary. This gives you a permanent record without having to remember to save manually.

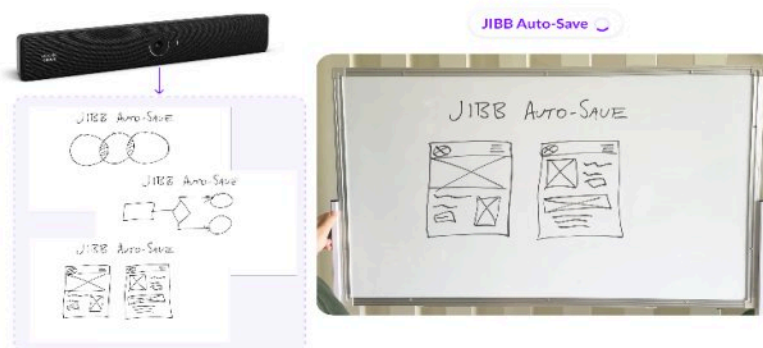

Why This Matters

Your automatic session records serve multiple purposes:

1. **Preserve ideas:** Never lose valuable input from brainstorming.
2. **Document evolution:** Watch how concepts developed throughout your session.
3. **Review later:** Reference past sessions when developing ideas further.
4. **Audit trail:** Create documentation for intellectual property evidence clarification.

 **Tip:** Create a folder in your email for JIBB Workspace session summaries—organize by project or date for easy reference later.

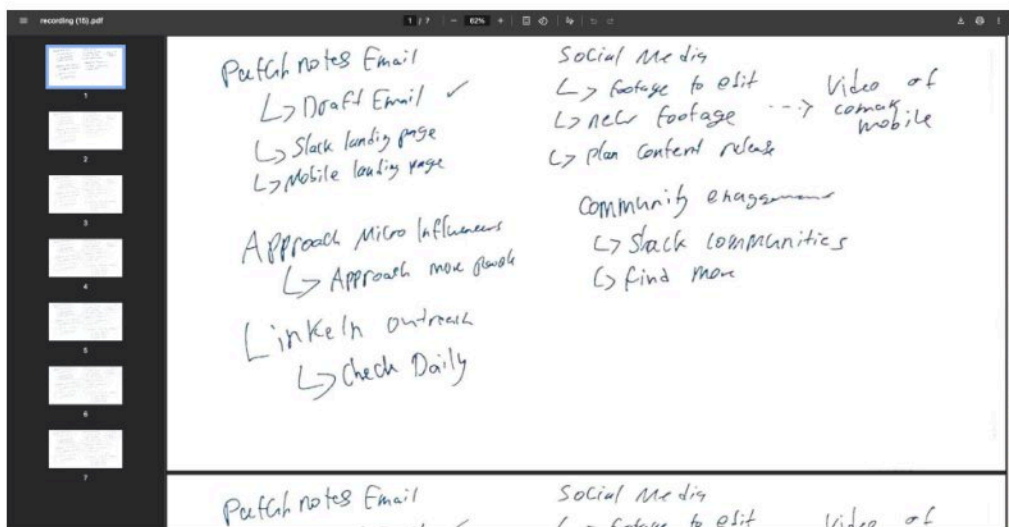

Digitize your Analog Work

JIBB Workspace pairs perfectly with Comak to digitize your analog work. Write and draw in JIBB Workspace, then convert everything to digital with Comak.

The Workspace → Comak Flow

1. Start a live session in JIBB Workspace as demonstrated before.
2. You can also collaborate in real-time as explained earlier.
3. Press stop to end the session.
4. Navigate to the three lines in the top left corner.

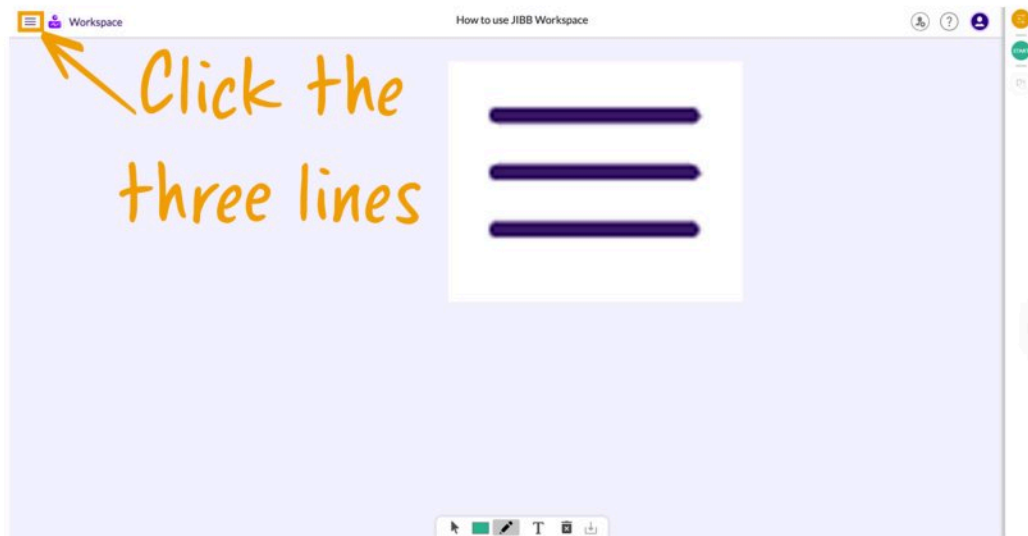

5. Select Comak from the dropdown.



- Find your Auto-save in Workspace Auto-Saves inside the Comak file uploader.

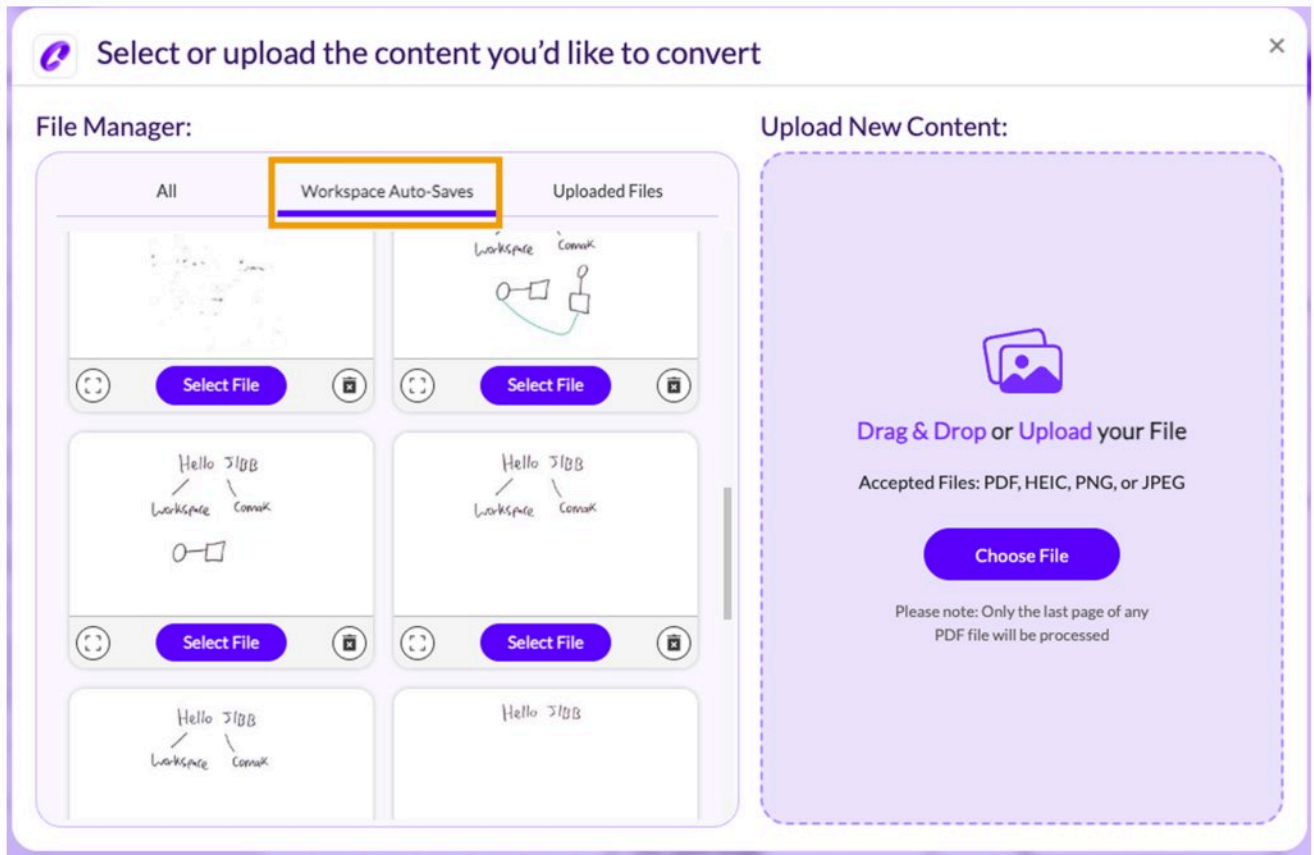

- Export the digital version of your drawings in PDF and other formats.

This workflow lets you collaborate freely with your team, then clean up the results for formal deliverables. No manual redrawing required.

 **Tip:** Learn how to use Comak by clicking [here](#).

You're Ready!

You've learned how to:

- ★ Set up your hardware and configure your workspace.
- ★ Frame your writing surface for optimal capture.
- ★ Share your work with collaborators in real-time.
- ★ Save and organize your sessions.

Next Steps:

1. Start your first session and experiment with the interface.
2. Invite a colleague to test collaborative features.
3. Try both Workspace and Comak to see which fits your workflow.
4. Explore advanced features as you get comfortable.

Need Help?

Visit our support resources:

1. Video tutorials at www.jibb.ai/help.html
2. Learn more about JIBB's technology at www.jibb.ai/resources/technology.html
3. Contact our team: support@jibb.ai

 **Remember:** Your first few sessions might feel slow as you adjust camera angles and get comfortable with the interface. That's normal! Most users find Jibb becomes second nature within 2-3 sessions.

Happy writing! 

Comak User Guide

Welcome to Comak! This guide shows you how to transform your hand-drawn sketches, diagrams, and notes into polished, editable digital formats. Let's turn your rough ideas into presentation-ready materials.

Getting Access

Visit jibb.ai to get started:

- **New to JIBB?** Start a free trial to explore features.
- **Already a subscriber?** Log in to access your account.

Setting Up Comak

When you sign in to your JIBB account (via app.jibb.ai), you will be navigated to your account home. Here you can select Comak to start converting your content.

1. Choose Your Product

JIBB offers two products for different needs:

- **Workspace:** For meetings, collaboration, and real-time sharing.
- **Comak:** For transforming sketches into polished diagrams.

This guide focuses on Comak. For real-time sharing of your visual work, please read the Workspace guide.

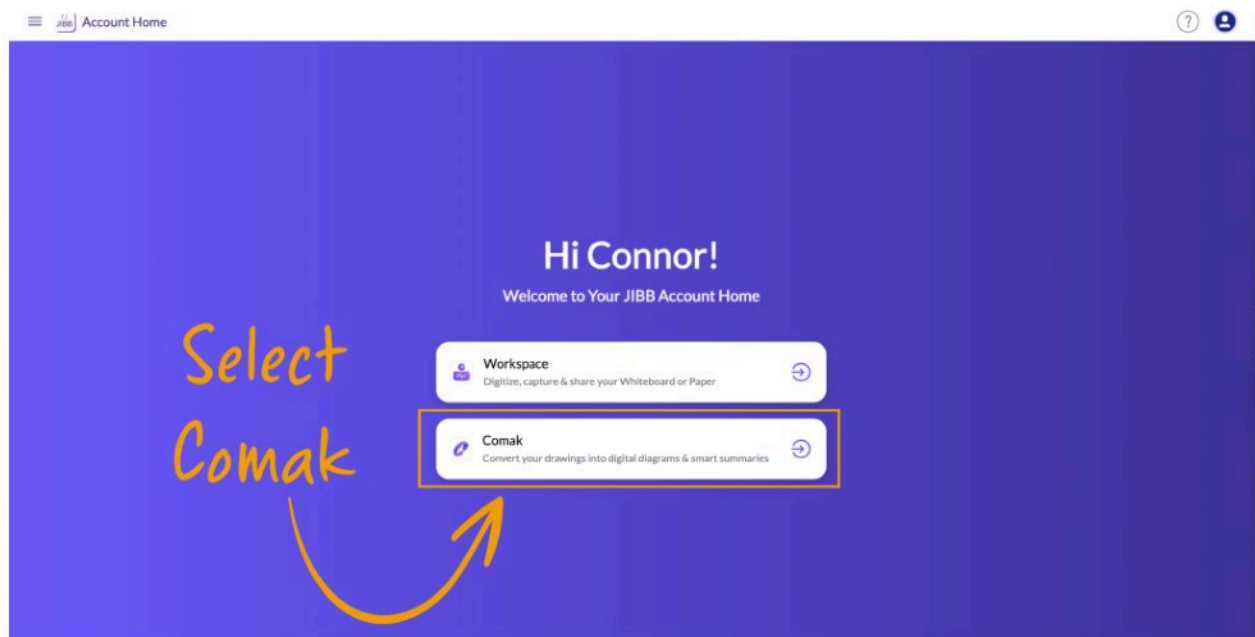

2. Connect to Lucidchart (Optional)

Want to send your diagrams directly to Lucidchart for further editing? Set up the integration first.

! Important: Log in to your Lucidchart account before starting this step to ensure a smooth connection.

How to Connect

1. Click the user icon in the top right corner.
2. Select Account Settings.

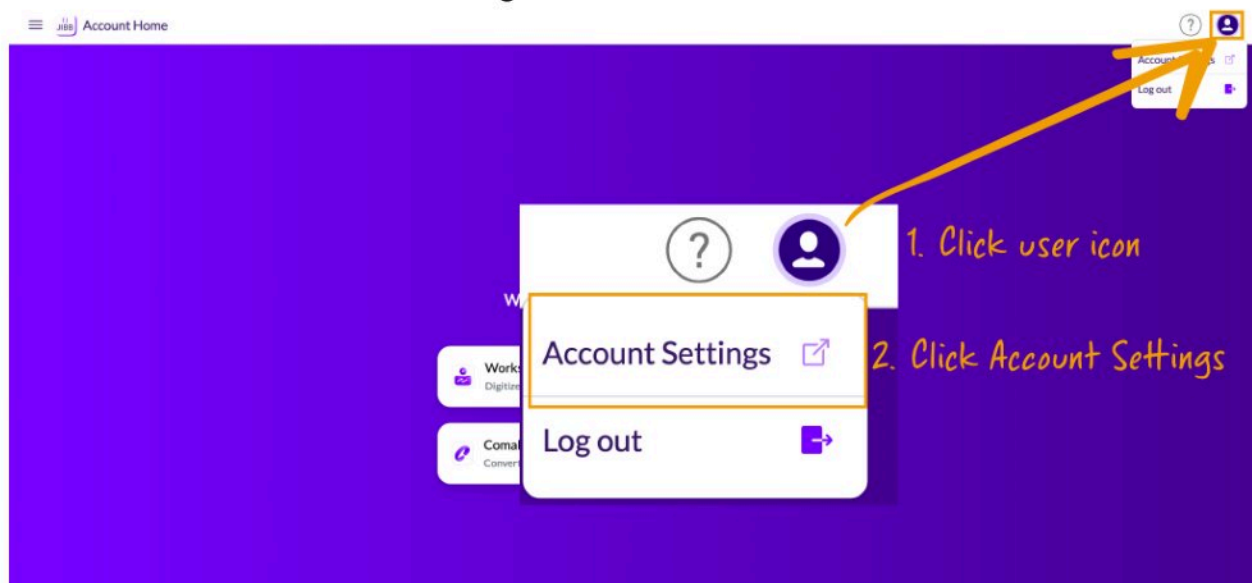

3. Navigate to Connected Apps.

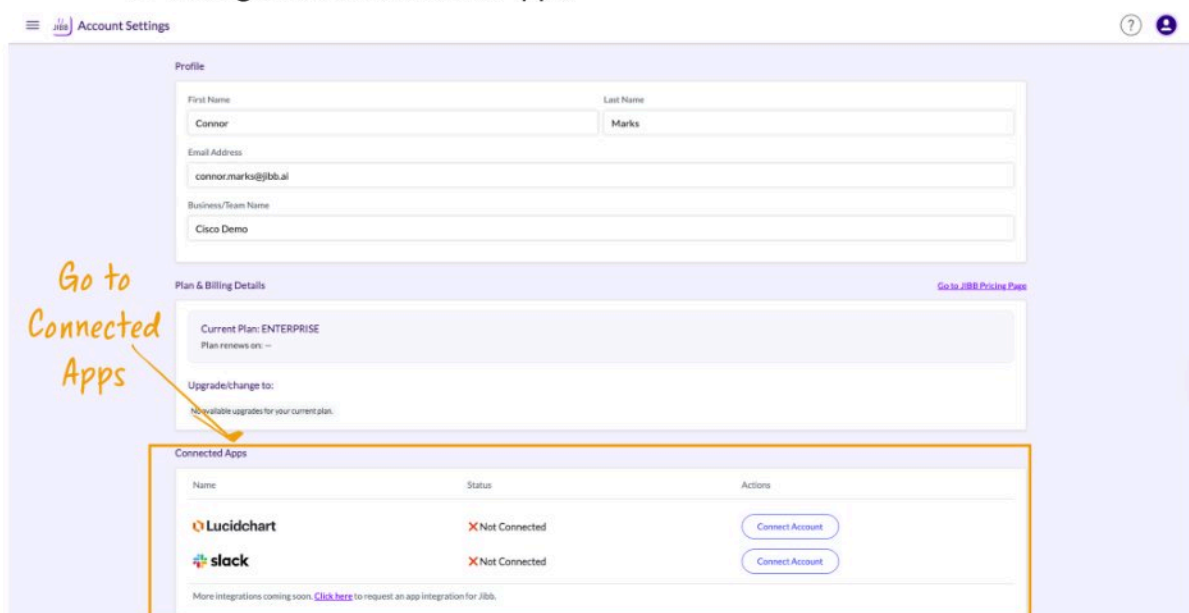

4. Click Connect Account next to Lucidchart.

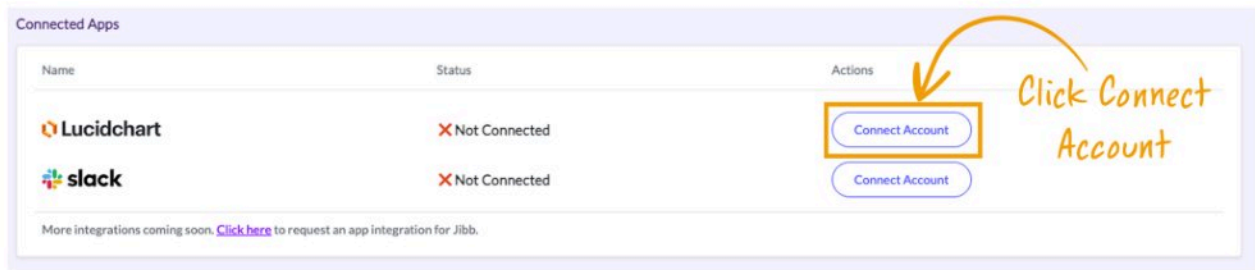

5. Review the permissions and click Grant Access.

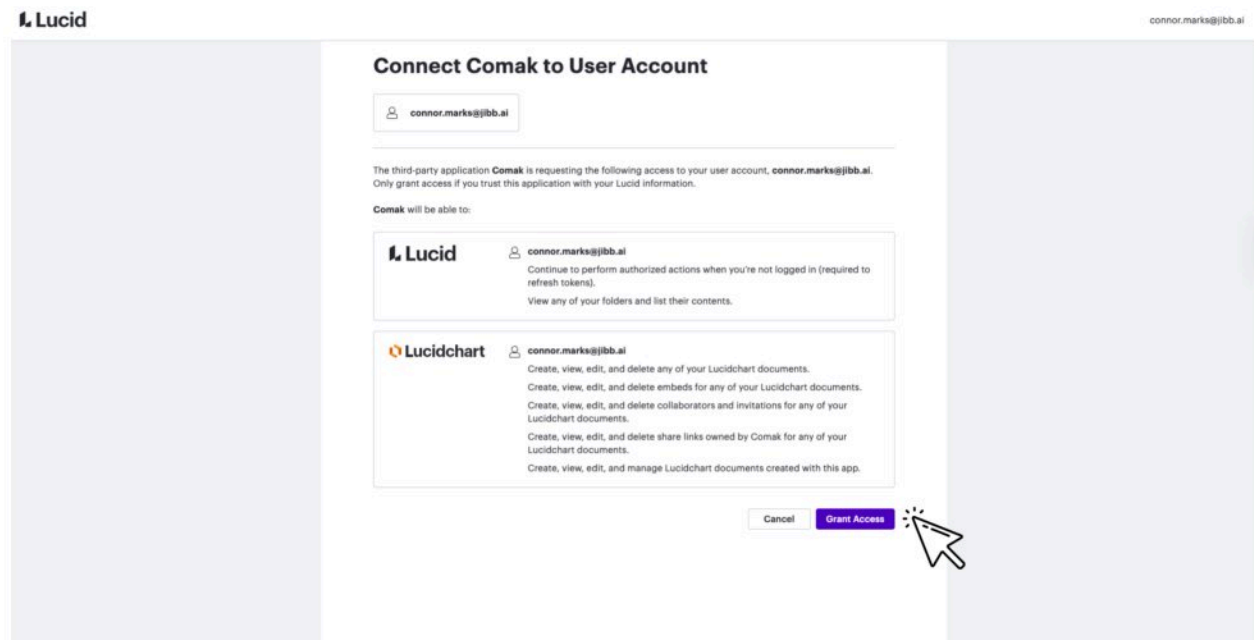

6. Return to Comak from the left panel menu.

Once connected, you can send your converted diagrams directly to Lucidchart with one click.

 **Note:** You can also access Account Settings from within Comak if you skip this step initially.

Using Comak

Now you're ready to convert a sketch into a digital diagram. Comak accepts files from multiple sources.

Choose Your File

The first step is to choose a file. There are three ways you can upload.

1. Upload a New File

- a. Drag and drop your image into the upload area.
- b. Or click to browse and select a file.

2. Use a Previous Upload

- a. Select from your previously uploaded files.
- b. Perfect for iterating on earlier conversions.

3. Use a Workspace Auto-Save

- a. Choose from saved PDFs from Jibb Workspace sessions.
- b. Seamlessly convert your live whiteboard sessions into polished diagrams.

Accepted file types: PDF, PNG, JPEG, HEIC

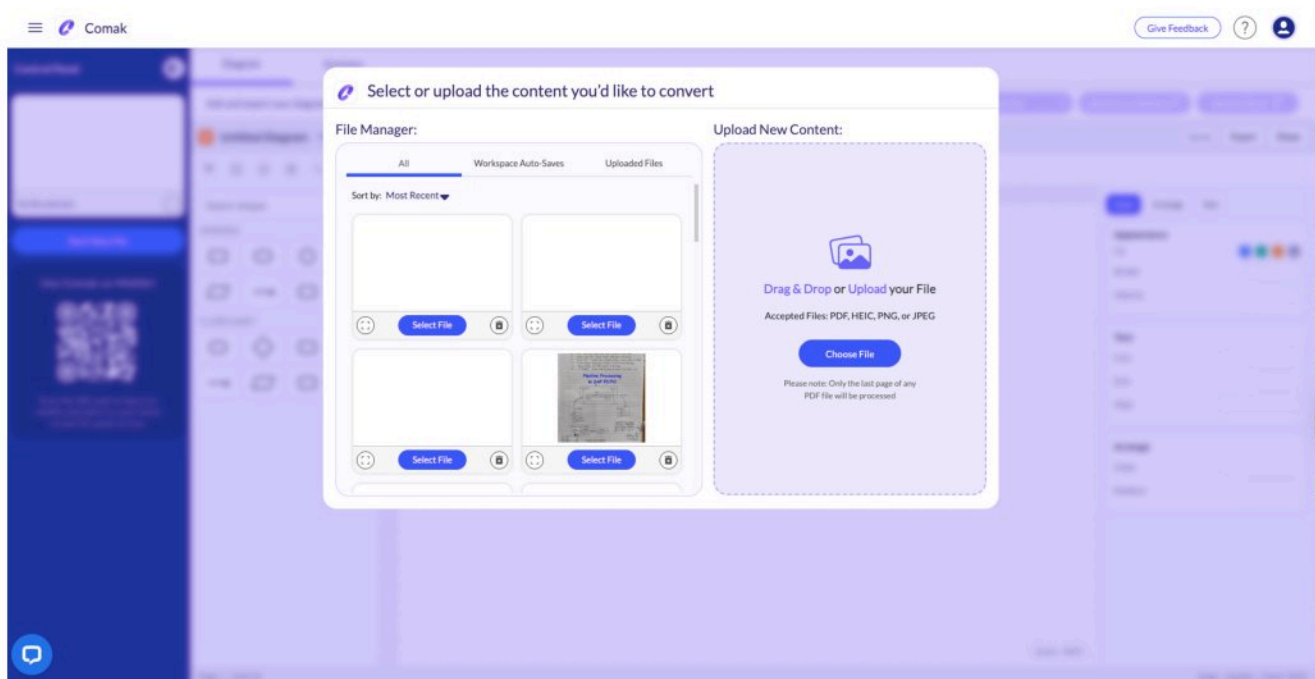

Generate Your Diagram

Once you upload a file, Comak analyzes your sketch and prepares it for conversion.

How to Generate

1. Comak analyzes your uploaded file automatically.
2. Once accepted, click Generate Diagram in the Diagram window.
3. Wait 2-3 minutes while Comak processes your sketch.

What happens during generation

- Comak scans your diagram's structure.
- Identifies shapes, connectors, and text.
- Recognizes key terms and relationships.
- Creates an editable digital version.

 **Tip:** Generation time depends on complexity. Detailed flowcharts with numerous elements take longer to create than simple diagrams.

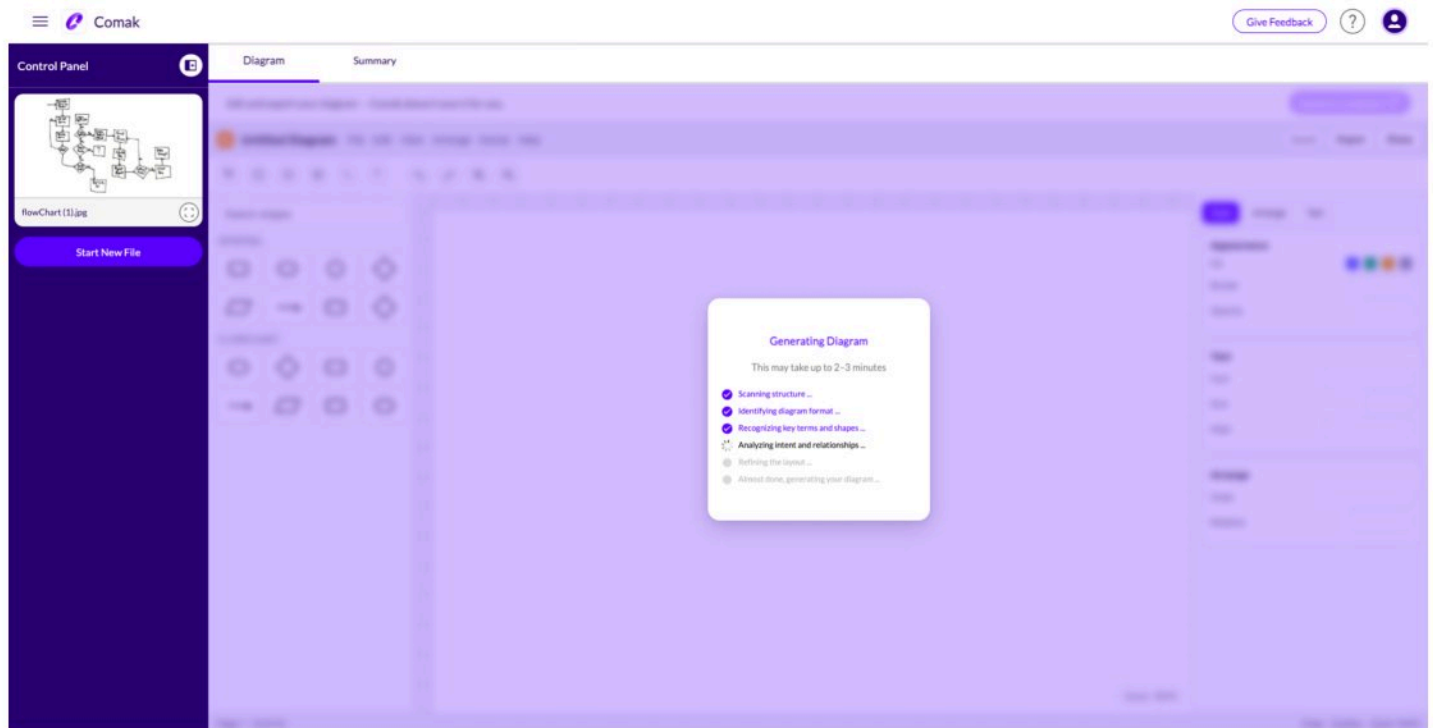

Edit & Polish Your Diagram

Your diagram appears in Comak's editor, where you can refine and perfect it.

Using the Editor

Review your converted diagram and make adjustments:

- Fix any text that wasn't recognized correctly.
- Adjust shapes, connectors, or positioning.
- Add missing elements or remove errors.
- Refine formatting and styling.

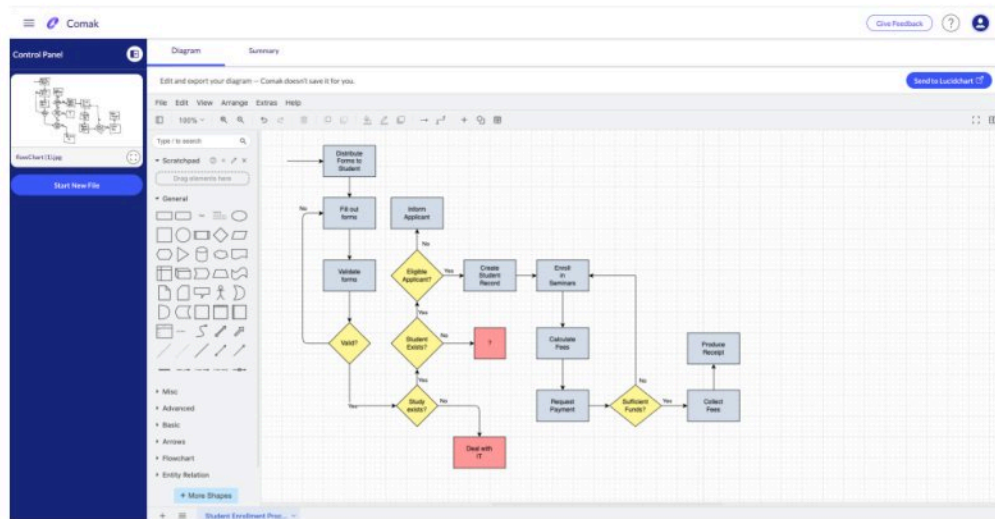

 **Pro Tip:** Click to expand your original uploaded file alongside the editor. This lets you compare side-by-side and quickly spot any differences that need correction.

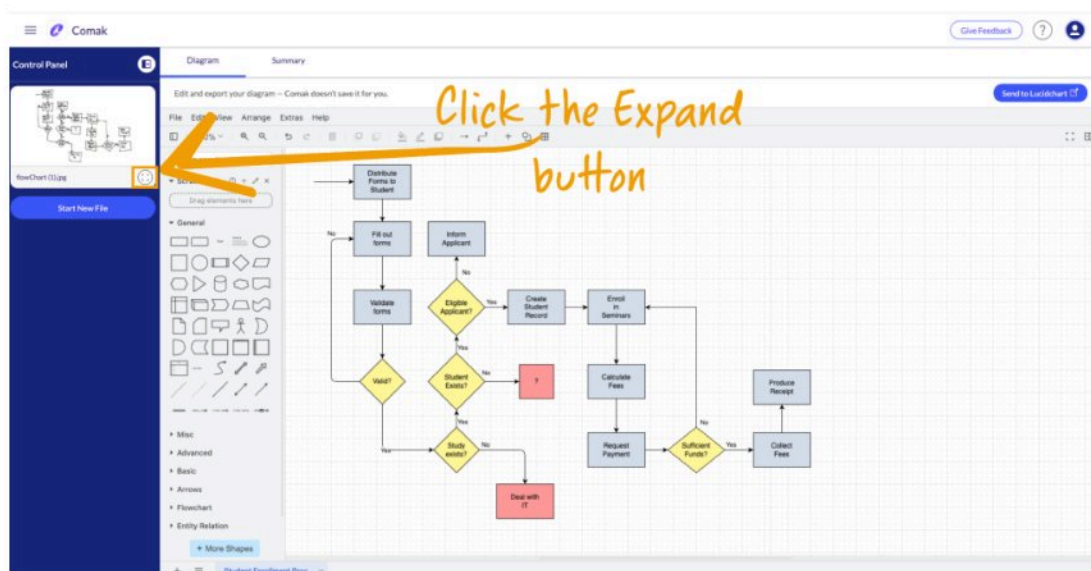

Export or Send Your Diagram

Your polished diagram is ready to use. Choose how you want to save or share it.

Send to Lucidchart

If you connected Lucidchart in Step 2, you can send your diagram directly:

1. Click Send to Lucidchart in the top right corner.
2. Choose the destination folder.
3. Click Send to Lucidchart.
4. Comak automatically opens your diagram in Lucidchart.

Continue editing in Lucidchart with full access to its advanced features.

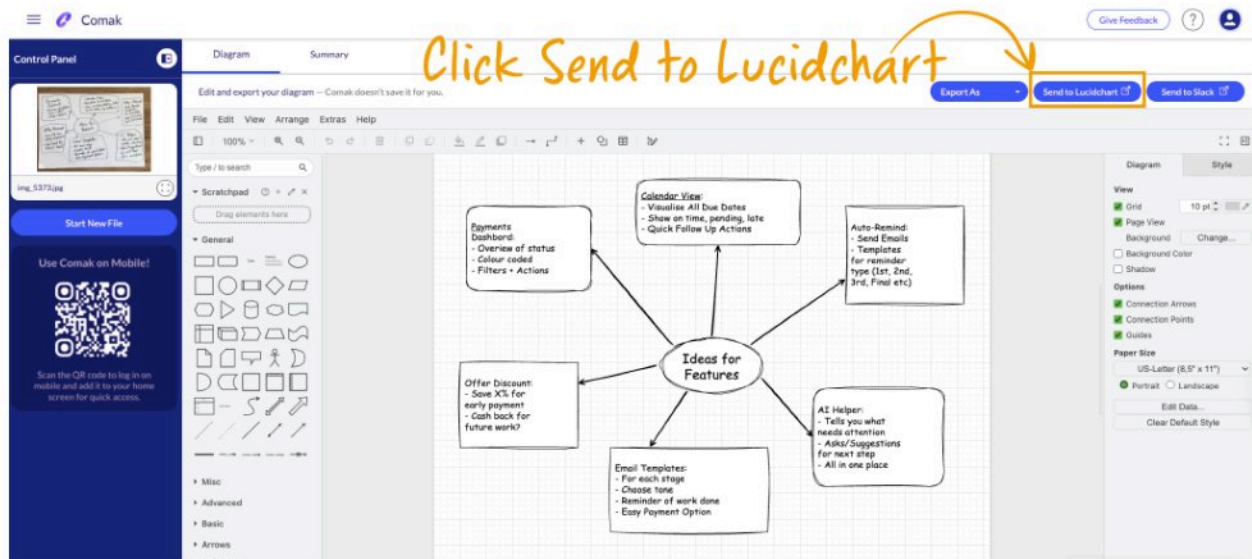

Download or Share

Prefer to work with the file directly? You have options:

- Download as an image or editable format (OPML & Markdown).
- Export to integrate with other tools.



Note: Check Comak's integrations menu for connections to Slack and other platforms.

Working with JIBB Workspace

Comak works seamlessly with JIBB Workspace for a complete workflow.

The Workspace → Comak Flow

1. Run a live session in JIBB Workspace with your team.
2. Collaborate in real-time with whiteboard sketching.
3. Receive auto-save PDFs of your session.
4. Find it in the Workspace Auto-Saves in Comak.
5. Export final diagrams to presentations or documentation.

This workflow lets you brainstorm freely with your team, then clean up the results for formal deliverables. No manual redrawing required.

 **Tip:** You can upload Workspace auto-save PDFs directly to Comak as well.

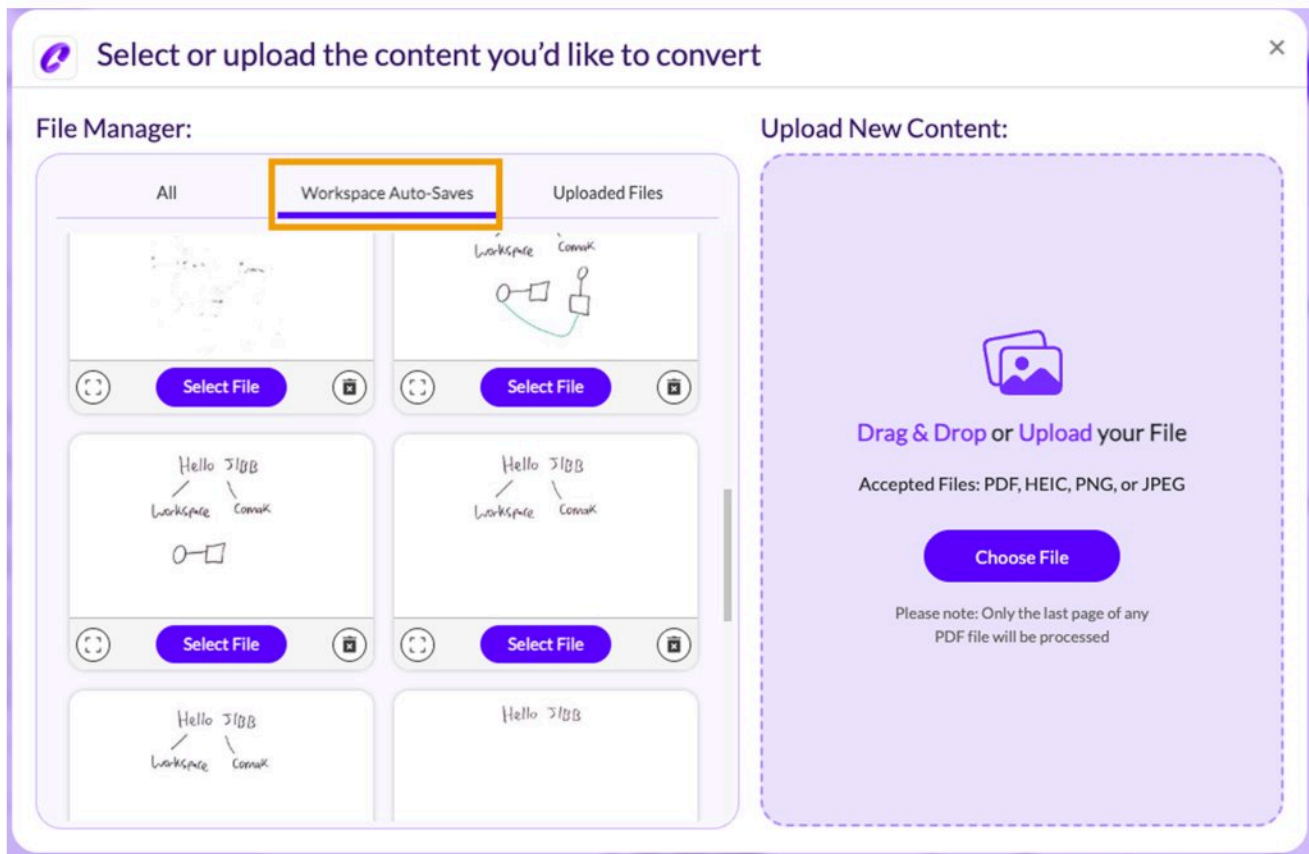

Using Comak on Mobile

Take Comak on the go by adding it to your mobile device's home screen.

Add to Home Screen

On iPhone/iPad:

1. Open Comak in Safari.
2. Tap the Share button.
3. Select Add to Home Screen.
4. Name it and tap Add.

On Android:

1. Open Comak in Chrome.
2. Tap the Menu (three dots).
3. Select Add to Home Screen.
4. Name it and tap Add.

Now, Comak launches like a native app, giving you quick access to convert sketches wherever you are.

 **Tip:** Mobile is perfect for converting whiteboard photos immediately after meetings—capture and convert before you even leave the room.

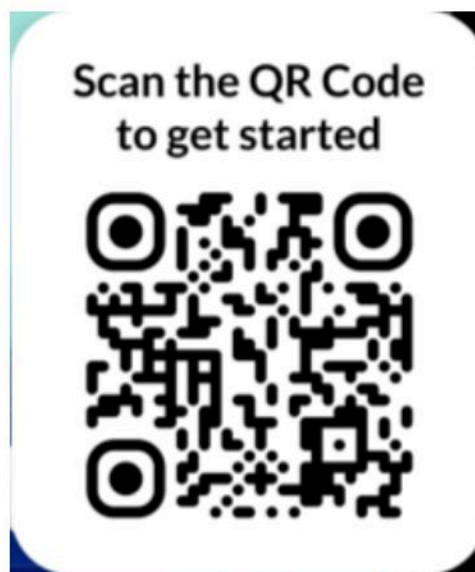

Integrations

Comak connects with the tools you already use, making it easy to incorporate your diagrams into existing workflows.

Available Integrations

1. JIBB Workspace

Digitize and save your drawings in real-time during live sessions, then polish them with Comak afterward.

2. Lucidchart

Send generated diagrams directly to Lucidchart for advanced editing and collaboration.

3. Slack

Share your diagrams or smart summaries to Slack channels for team visibility.

Want more? Request additional integrations at jibb.ai/integrations—we're constantly expanding our connections.

You're Ready!

You now know how to:

1. Upload sketches from multiple sources.
2. Generate polished diagrams from rough drawings.
3. Edit and refine your converted diagrams.
4. Export to Lucidchart and other platforms.
5. Get the best conversion results.

Next Steps:

1. Convert your first sketch and explore the editor.
 2. Set up Lucidchart integration if you use it regularly.
 3. Try the Workspace → Comak workflow for team sessions.
 4. Add Comak to your mobile device for on-the-go conversions.
-

Need Help?

Comak is continuously improving with new features and optimizations. If you encounter any issues or have suggestions, we'd love to hear from you.

Get Support

- Contact our team: support@jibb.ai
- Share feedback: comak.ai/feedback
- Request integrations: comak.ai/integrations/request